

# KEENE LAND

SOHO VENEER COLLECTION

*DMI*  
DMI OFFICE FURNITURE



7845

Bourbon Cherry Finish

# SOHO

# K E E N E L A N D

SOHO VENEER COLLECTION 7845

2



*Construction - Construction consists of cherry veneers, select hardwoods and wood product with a Bourbon Cherry finish, including solid wood pilasters and mouldings. Drawers feature a four-sided construction of 7/16" solid material screwed to drawer fronts featuring solid maple/poplar framing over cherry veneer panels.*



*Styling - Traditional / transitional design featuring reverse-diamond match cherry panels, cross-banded with figured cherry veneers and highlighted with inlaid walnut bands. Additional design details include half-rounded columns and "break-front" decorative base detail.*



*Function - All drawers are suspended on ball bearing slides. Box drawers have 100 lb. rated slides; file drawers have 150 lb. rated slides and keyboards have a 50/75 lb. rating. All file drawers are equipped to accommodate front-to-back letter sized or side-to-side legal sized hanging file folders. All cases are equipped with levelers to adjust for less than even flooring.*



*Computer applicable furniture features cable grommets or other access openings for easy and neat computer cable management.*





Keeneland - a name synonymous with the picturesque Kentucky Bluegrass - dedicated to preserving the rich heritage of the thoroughbred industry while also promoting innovation. This thoroughbred icon serves as inspiration for our Keeneland Series, a traditional / transitional collection of office / home-office furnishings featuring elegant, reverse-diamond match cherry veneer panels, cross-band with figured cherry veneers and highlighted with inlaid walnut bands surrounded by ornately shaped picture frame mouldings. Other details include half-rounded columns and "break-front" decorative base detail. The series is solidly constructed on wood, wood veneer and select wood product with a rich Bourbon Cherry finish. Construction includes solid wood pilasters and mouldings. All drawers have finished wood interiors and are suspended on black, full extension, ball-bearing slides. All drawers also feature English dovetail construction.



SOHO

# K E E N E L A N D

SOHO VENEER COLLECTION 7845

5

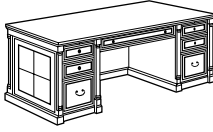

## EXECUTIVE DESK

**7845-36**  
W74 D36 H30

- Drop-front center drawer with a removable pencil tray can function as a center drawer or keyboard drawer. Back of the drawer is notched for cable management.
- Pull-out writing board / felt-lined box / box with wood dividers / file drawer per pedestal.
- Knee-hole locking pedestals secure middle box and file drawer.
- Cable grommets in front corners of desk top.

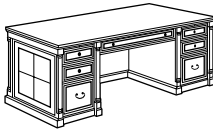

## EXECUTIVE DESK

**7845-34**  
W66 D30 H30

- Same features as the 7845-36

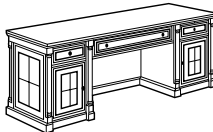

## COMPUTER CREDEZZA

**7845-23**  
W73 D24 H30

- Drop-front keyboard tray with a power manager; back is notched for cable management.
- Pull-out writing board / felt-lined box drawer with a wood pencil tray / cabinet per pedestal. Each cabinet has one adjustable shelf.
- Cable accessible.

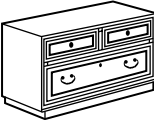

## KNEE-HOLE STORAGE UNIT

**7845-14**  
W34 D22 H22

- Use in knee-hole of -23 Computer Credenza or as a stand alone storage unit.
- Two felt-lined box drawers.
- Locking file drawer accommodates letter and / or legal hanging files.

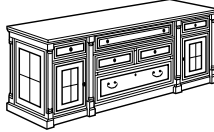

## COMPUTER CREDEZZA WITH KNEE-HOLE STORAGE

**7845-235**  
W72 D24 H30

Consists of:  
-23 Computer Credenza  
-14 Knee-hole Storage Unit

- See 7845-23 and 7845-14 above for specifications.

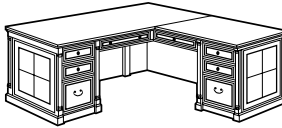

## EXECUTIVE RIGHT "L" DESK

**7845-57**  
W74 D90 H30

Consists of:  
-570 Left Single Pedestal Desk  
W74 D36 H30  
-579 Right Single Pedestal Return  
W54 D24 H30

ALSO AVAILABLE:

## EXECUTIVE LEFT "L" DESK

**7845-58**

-580 Right Single Pedestal Desk  
-589 Left Single Pedestal Return

## DESK FEATURES:

- Center drop-front drawer with a removable pencil tray can function as a center drawer or a keyboard drawer; back of drawer is notched for cable management.
- Pull-out writing board / box / box / file drawer.
- Knee-hole locking pedestals secure middle box and file drawer.

## RETURN FEATURES:

- Center drop-front keyboard tray.
- Pull-out writing board / CPU compartment with power manager, phone jack, CD drawers.

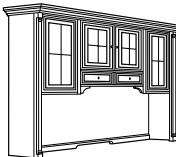

## OVERHEAD STORAGE

**7845-62**  
W74.25 D16 H48

- Three storage compartments, each with an adjustable shelf.
- Pull-out task lighting unit illuminates work surface.

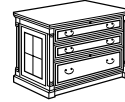

## LATERAL FILE

**7845-16**  
W39 D24 H30

- Two fully extending file drawers accommodate letter and / or legal hanging files.
- Equipped with an anti-tip device.



## FOUR DOOR BOOKCASE

**7845-06**  
W36 D16 H79

- Two cabinets, each with an adjustable shelf.
- Open storage compartment.

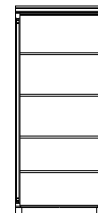

## OPEN BOOKCASE

**7845-08**  
W36 D16 H79

- Two fixed and three adjustable shelves.



## EXECUTIVE HIGH BACK CHAIR

**7845-831, Black Leather**

**7845-832, Brown Leather**

W27.5 D28 H37.75-41.75

- Five star, casted base.
- Swivel and knee-tilt mechanism.
- 20" seat depth, 19" seat width.
- 17"-21" seat height (from floor).



## HIGH BACK GUEST CHAIR

**7845-821, Black Leather**

**7845-822, Brown Leather**

W27.5 D28 H41

SOHO



*DMI Office Furniture  
9780 Ormsby Station Road  
Ste 200  
Louisville, KY 40223  
502.426.4351  
(Fax) 502.429.6285  
[www.dmiofficefurniture.com](http://www.dmiofficefurniture.com)*



MEMBER  
**BIFMA**  
INTERNATIONAL